

# THE BEST SOLUTION

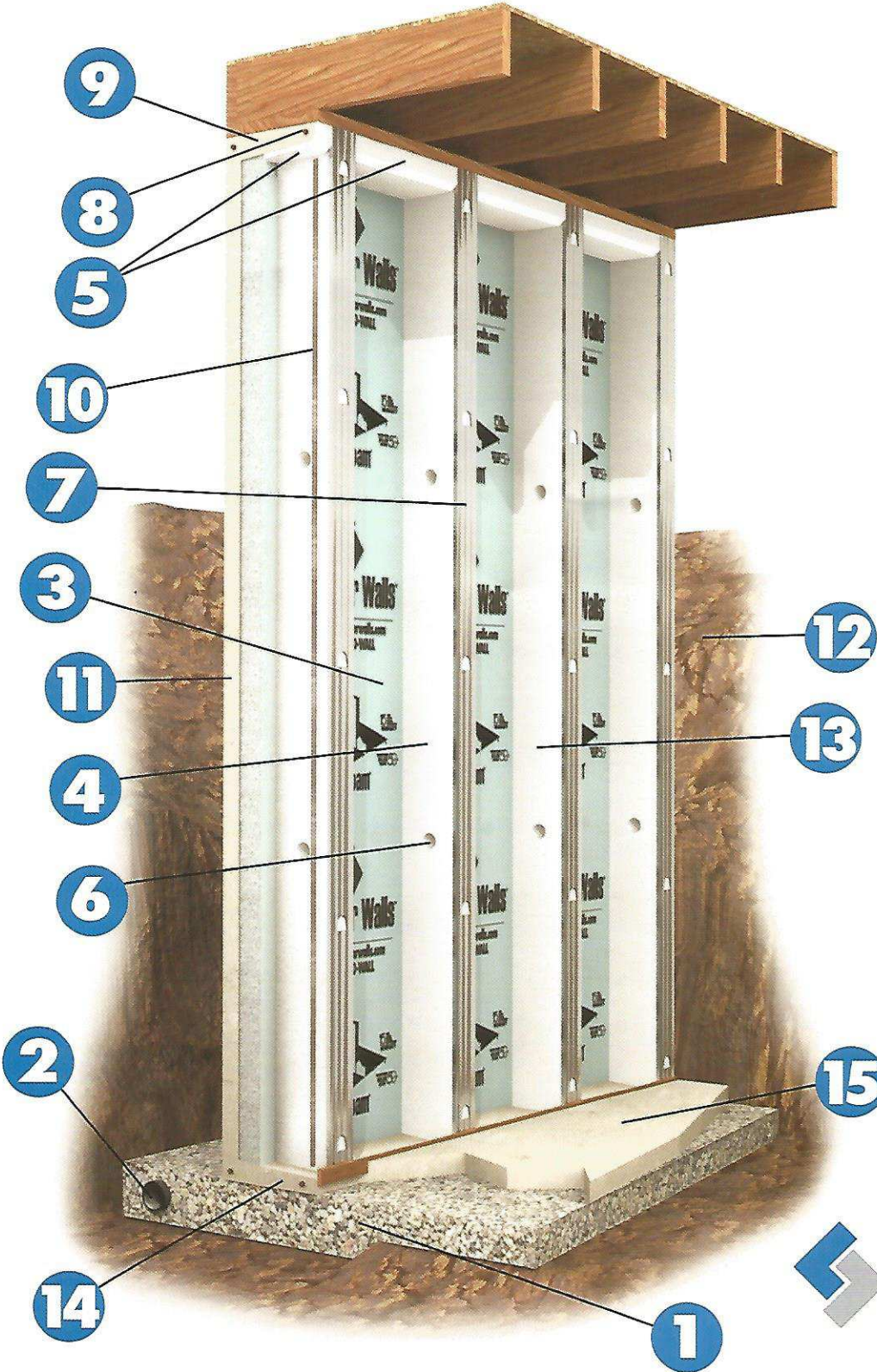

## SUPERIOR WALLS Xi FOUNDATION SYSTEM



## DRY

Your permanent barrier against sidewall water penetration

- ① Clean Crushed Stone Footing
- ② Auxiliary Drain Pipe
- Superior Sealant® Applied in All Joints for Permanent Moisture Barrier

## WARM

Warmer in winter, cooler in summer... reduces your home's energy loss

- ③ 2-1/2" Dow® Extruded Polystyrene Insulation
- ④ 1" Foam Insulated Concrete Studs
- ⑤ 1" Foam Insulation on Bond Beam

## SMART

Ready to finish...with pre-engineered access built-in

- ⑥ Access Holes for Ease in Wiring and Plumbing
- ⑦ Galvanized Steel Stud Facing Ready for Drywall Finishing
- CAD Custom-Designed to Virtually Any Home Style
- Laser-Leveled to be Plumb, Level, Square
- Installs on Your Site in Just Hours for Time and Money Savings
- America's Strongest Foundation Guarantee\*

## SUPERIOR

Steel reinforced...and backed by the industry's strongest guarantee\*

- 5,000+ PSI Concrete for Superior Strength
- ⑧ Horizontal Steel Rebar Inside Top and Bottom Beams
- ⑨ Steel Reinforced Top Bond Beam
- ⑩ Vertical Steel Rebar (Inside Each Stud)
- ⑪ 1-3/4" Concrete Face Shell
- ⑫ 10-1/4" Overall Wall Thickness
- ⑬ Steel Reinforced Concrete Studs
- ⑭ Steel Reinforced Footer Beam
- ⑮ Concrete Floor

*Special Note: Items #1,2,&15 as well as the joist/flooring system are provided on site per Superior Walls specifications by builder and contractors as an integral part of the Superior Walls foundation system.*

*\*See the limited warranty. Contact your local Superior Walls representative for details.*



## Superior Walls®

THE FOUNDATION  
OF EVERY SUPERIOR NEW HOME™

[www.superiorwalls.com](http://www.superiorwalls.com)